

Pole Mount Light 2A

Installation Guide for 701955-5WXAX2

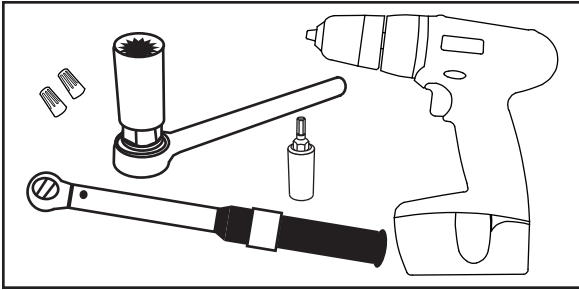

Tools and Supplies Required: Cordless drill, 1/2" drill bit, 7/16" deep socket and ratchet, 5 mm hex bit for M10 x 1.5 set screws, torque wrench with capacity above 100 in*lb, 16 mm wrench for M10 x 1.5 hex nuts, and twist-on or push-in UL Listed wire connectors for 14/18 AWG. **Optional:** Top mount tenon – See note under vertical mount instructions (sold separately).

NOTE:

New Installation refers to mounting to a new/replaced bare square pole. Requires Tenon Accessory Kit (P/N 601102).

Replacement Installation refers to the complete removal and replacement of an existing fixture onto a bare square pole. Requires Tenon Accessory Kit (P/N 601102).

Retrofit Installation refers to an installation using an existing 2" nominal tube (2.38" [60 mm] actual OD) to connect the light to the pole.

If a round pole is present in **New** or **Replacement Installations**, a Round Pole Tenon Kit (P/N 601017) is also required.

NOTE: SloanLED requires this fixture be installed on a Daylight Sensor or Timer Circuit that switches off during daylight hours to maximize energy savings and extend product life. Required for California Title 24 Compliance.

NOTE: The light source of this luminaire is not replaceable; when light source reaches end of life, the whole luminaire shall be replaced.

CAUTION, risk of electric shock



Preparation for Installation

NOTE: Prior to commencing work, a licensed electrician must lockout and tagout all associated breakers or switches as required by local electrical code.

New Installation: Mark and drill 1/2" diameter holes in pole at desired height with wire pass-through in center of hole pattern. Use tenon as a guide for desired hole location (refer to Recommended Hole Pattern diagram on page 3).

Replacement/Retrofit Installation: Disconnect wiring from old fixture and remove fixture from pole. Tenon Accessory Kit (P/N 601102) is designed to work with a variety of existing hole patterns. Mark and drill 1/2" diameter holes as required for hole patterns not compatible with Tenon Accessory Kit.

WARNING: THE INSTALLER IS RESPONSIBLE FOR SUPPORTING THE LUMINAIRE DURING A RETROFIT INSTALLATION.

Opening and Closing Luminaire

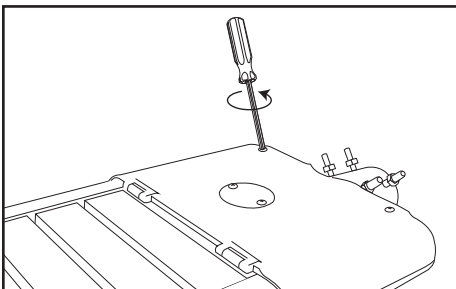

1. Opening Luminaire – Loosen captive socket head cap screws (4 mm hex).

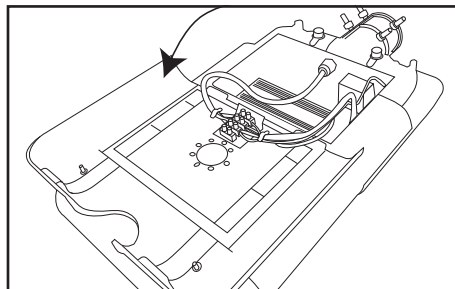

2. Release latches to open enclosure. Enclosure cover rests on top of luminaire.

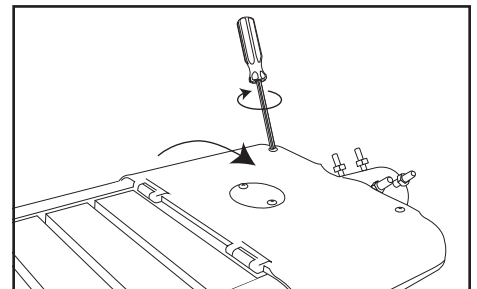

NOTE: Ensure internal cabling doesn't get pinched.

3. Closing Luminaire – Close luminaire. Tighten socket head cap screws.

Pole Mount Light 2A

Installation Guide for 701955-5WXAX2

Rotating Slipfitter

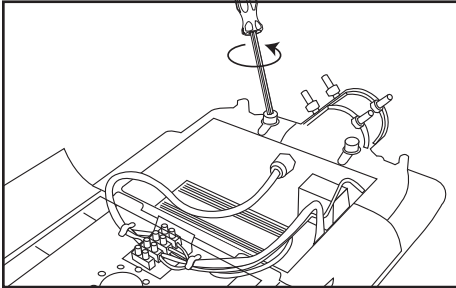

1. Follow steps for "**Opening and Closing Luminaire**". Remove socket head cap screws and washers from slipfitter (8 mm hex).

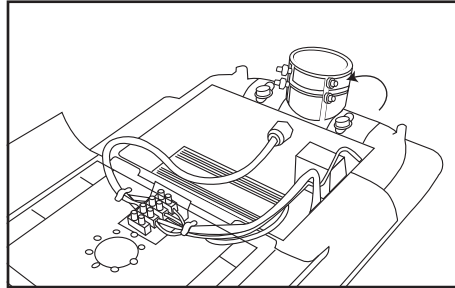

2. Rotate slipfitter as necessary.

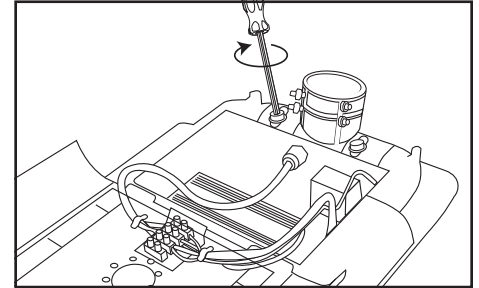

3. Replace and tighten bolts (100 in*lb) and washers.

New/Replacement Installation (Ø 2.38" [60 mm] Bare Round Pole) – Vertical Mount

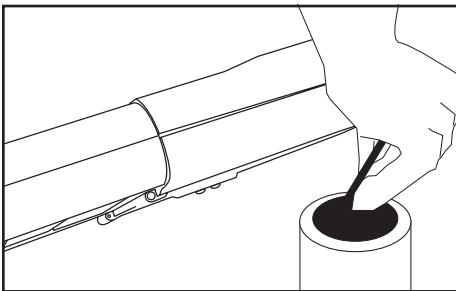

1. First, follow the instructions on "**Opening and Closing Luminaire**" (page 1) and the instructions on "**Rotating Slipfitter**" above.

NOTE: If pole diameter is larger than Ø 2.38" (60 mm), use a top mount tenon (sold separately).

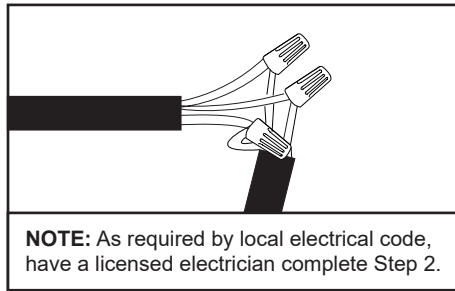

NOTE: As required by local electrical code, have a licensed electrician complete Step 2.

2. Attach main branch wiring exiting pole to luminaire harness. Pole Mount Light 2A power supply input wire colors are as follows:

Line – Brown
Neutral – Blue
Ground – Green/Yellow

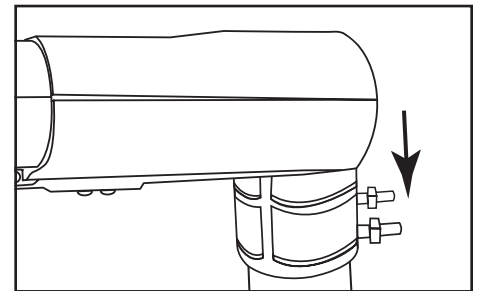

3. Lift luminaire and align slipfitter and pole. Insert wire connections/bundle into luminaire tube. Excess wire may be inserted into tenon. Slide slipfitter onto pole.

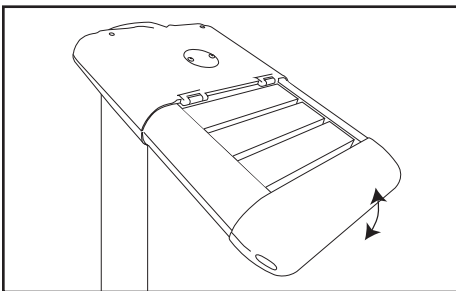

4. If orientation requires further tilt adjustment, lockout and tagout primary power see instructions on "**Rotating Slipfitter**" above.



5. **Final Installation Check:** Check operation and desired orientation upon energizing power.

Pole Mount Light 2A

Installation Guide for 701955-5WXAX2

New/Replacement Installation (Bare Square Pole) – Horizontal Mount/Factory Configuration

Retrofit to existing tenon – Begin at Step 3

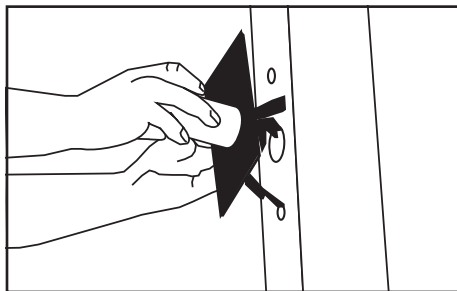
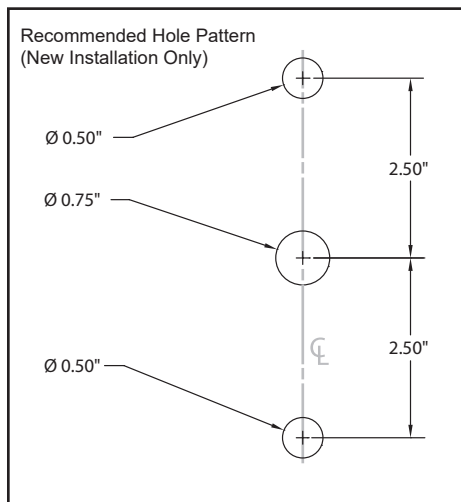

1. To install Tenon Accessory Kit, ensure slot for center tube of tenon is oriented to 6 o'clock position and feed incoming AC power wires (Line, Neutral, Ground) through center of tenon. Loosen 1/4-20 nuts for attachment bolts - approximately 4 turns - keeping toggles oriented to bolt centerlines. Insert both toggles into pole until flange of tenon contacts pole.

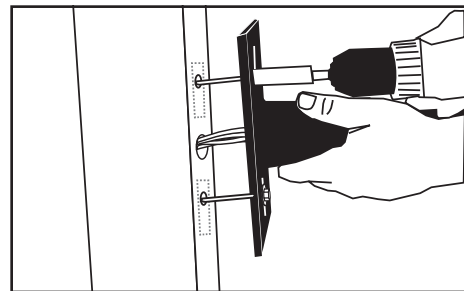

2. Rotate bolts so that toggles turn inside pole and fall into vertical orientation. Bolts can easily be tightened by pulling on tenon as shown. Tighten bolts to bring toggles into internal contact with pole and tighten to 100 in*lb torque.

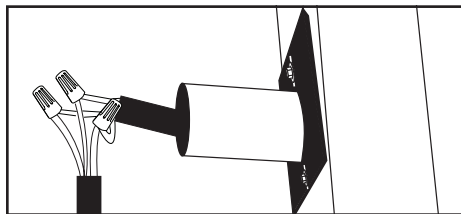

NOTE: As required by local electrical code, have a licensed electrician complete Step 3.

3. Attach main branch wiring exiting pole to luminaire harness. Pole Mount Light 2A power supply input wire colors are as follows:

Line – Brown
Neutral – Blue
Ground – Green/Yellow

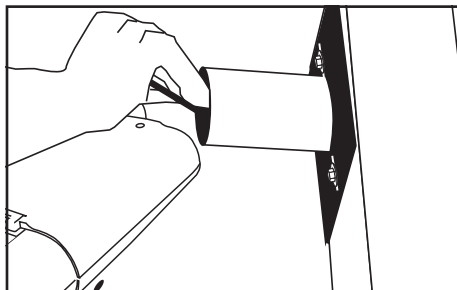

4. Loosen M10 x 1.5 nuts on set screws. Insert wire connections/bundle into luminaire tube. Excess wire may be inserted into tenon.

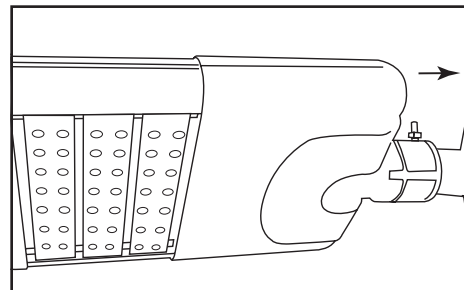

5. Lift luminaire and align slipfitter and tenon. Slide slipfitter onto tenon.

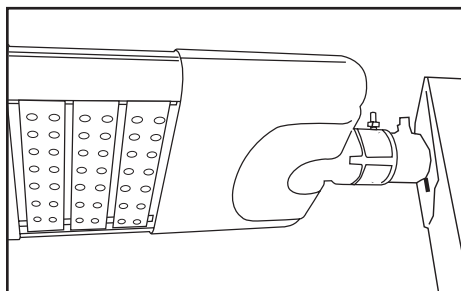

6. Orient light on tenon at desired angle. Most applications will have luminaire oriented horizontally. Rotate luminaire as desired. Tighten M10 x 1.5 set screws to 100 in*lb. After set screws are tightened, lock them in place with M10 x 1.5 nuts, torqued to 100 in*lb.

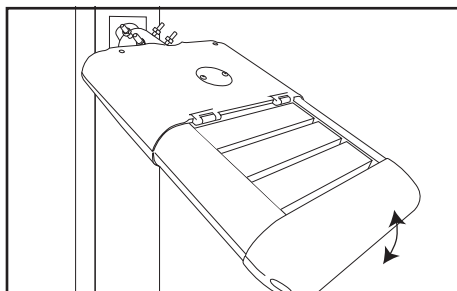

7. If orientation requires further tilt adjustment, lockout and tagout primary power and see instructions on "Rotating Slipfitter" on page 2.



8. **Final Installation Check:** Check operation and desired orientation upon energizing power.

Pole Mount Light 2A

Installation Guide for 701955-5WXAX2

143 VDC power supply capacity chart for Pole Mount Light 2A

Part number	Input		Output		
	Nominal input voltage	Input current	Power output	Output current	Luminaire per power supply
410157-100	100-277 VAC, 50-60 Hz	1.2 - 0.6 A	100 W Max	0.7 A	1

Optional Accessories

Part number	Part name	Application
601102	Square Pole Tenon Kit	Required for horizontal mounting onto a bare square pole.
601017	Round Pole Tenon Kit	Required for horizontal mounting onto a bare round pole.

Troubleshooting

NOTE: A licensed electrician should perform all applicable steps.

Light does not turn on.	1.	Ensure all safety tags and lockouts removed. Ensure all breakers and local switches energized.
	2.	Check light circuit for motion dimming, daylight sensing, or other timed/motion/daylight circuit. Check respective manufacturer's guide for proper operation.
	3.	Ensure no loose connections in main branch wiring. Ensure proper wiring configuration for Line, Neutral, and Ground.
	4.	Check connection from power supply lead to luminaire. Open luminaire cover and verify all wire connections are properly made.
	5.	If power supply is getting primary power, has correct output, and luminaire does not light, there may be a short in secondary wiring. Check all connections and condition of wires. Measure luminaire input resistance across red and black leads. This should be an open circuit on typical handheld multimeters. Any positive reading indicates short within luminaire. Replace luminaire.