

# Brilliance by Design

Incandescent Lamp Replacement LEDs



**SloanLED**<sup>®</sup>  
A Principal Industries Company

# Incandescent Lamp Replacement LEDs

Replace your standard incandescent lamps with long life, low power LEDs. These products are designed to be “drop in” replacements for the most popular miniature lamps in use today. Offered in a wide variety of colors and voltages, our incandescent replacement products will solve your bulb maintenance problems.

## Table of Contents

**Model 197** .....3  
*T-3 1/4 Bayonette Base LED Lamp*

**Model 460** .....4  
*S8 Machine Signal Stack Light*

**Model 510** .....5  
*T-1 3/4 LED Direct Replacement for Flange Base Incandescent Lamp*

**Model 513** .....6  
*T-1 3/4 LED Replacement for Incandescent Lamps*

**Model 516** .....7  
*T-3 1/4 LED Replacement for Incandescent Lamps*

## Incandescent Lamp Specifications

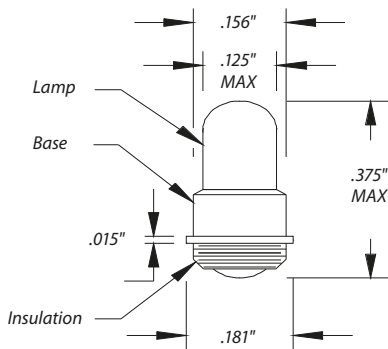

### T-1 Flange Base Lamps

Part Number	Design Voltage	Design Current (Amperes)	Light Output (M.S.C.P.)	Life Hours
FB12	5.0	.060	.050	100,000
FB59	28.0	.024	.150	16,000
FB60	5.0	.060	.050	100,000

### T-1 Unbased Lamps

Part Number	Design Voltage	Design Current (Amperes)	Light Output (M.S.C.P.)	Life Hours
F59	28.0	.024	.150	16,000

# Model 197

## T-3 1/4 Bayonette Base LED Lamp

BA9 base incandescent replacement LED for incandescent lamps. All models are dual polarity, which accommodate positive center, negative center and AC applications. This unit uses a cluster of high brightness LEDs for maximum illumination at low power consumption.

- Direct replacement for: 24MB, 28MB, 44, 47, 313, 356, 756, 1813, 1818, 1819, 1820, 1821, 1829, 1862, 1864, 1866, 1891

## Specifications

### Warm Colors

LED size	3 mm		
Lens color	Waterclear		
LED color	Red	Yellow	Amber
Typical luminous intensity	1000 MCD	500 MCD	1100 MCD
Viewing angle	30°	30°	30°
Wavelength	R660	Y592	O610

### Cool Colors

LED size	5 mm			
Lens color	Waterclear			
LED color	Green	Ultra Green	Ultra Blue	White
Typical luminous intensity	350 MCD	2200 MCD	650 MCD	2500 MCD
Viewing angle	30°	30°	30°	110°
Wavelength	G565	G525	B470	-

### Dual Polarity

Part number	Voltage	Part number	Voltage
197-DP5X	5 V	197-DP28X	28 V
197-DP12X	12 V	197-DP48X	48 V
197-DP24X	24 V	197-DP120X	120 V

Where the 'X' appears insert:  
1-Red, 2-Green,  
3-Yellow, 4-Amber,  
7-Pure White

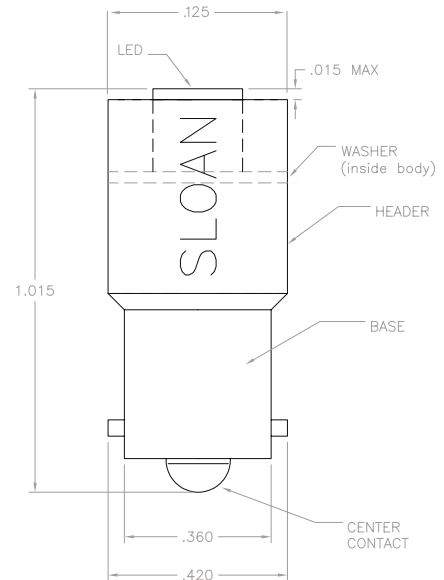

All dimensions are in inches.

### HOW TO ORDER DUAL POLARITY

Example:

197 DP - 5 1

MODEL NO.

DUAL POLARITY

VOLTAGE

COLOR

### HOW TO ORDER AC

Example:

197 AC - 12 1

MODEL NO.

AC

VOLTAGE

COLOR

### HOW TO ORDER NEGATIVE CENTER

Example:

197 NC - 12 7

MODEL NO.

NEGATIVE CENTER

VOLTAGE

COLOR

# Model 460

## S8 Machine Signal Stack Light

Bayonet base LED stack light. 360 degree viewing angle. All models are dual polarity which accommodates positive center, negative center and AC applications.

- BA15D Double contact bayonet base

### Specifications

LED size	5 mm
Lens color	Waterclear

#### Warm Colors

LED color	Red	Yellow	Amber
Typical luminous intensity	3000 MCD	3000 MCD	4000 MCD
Viewing angle	30°	22°	18°
Wavelength	R630	Y595	A605

#### Cool Colors

LED color	Green	Ultra Green	Ultra Blue	White
Typical luminous intensity	750 MCD	2200 MCD	650 MCD	6000 MCD
Viewing angle	22°	30°	30°	50°
Wavelength	G568	G525	B470	-

Part number	Voltage
460-24X	24 V
460-28X	28 V
460-120X	120 V

Where the 'X' appears insert:  
 1-Red, 2-Green, 3-Yellow, 4-Amber,  
 5-Ultra Green, 6-Ultra Blue, 7-Pure White

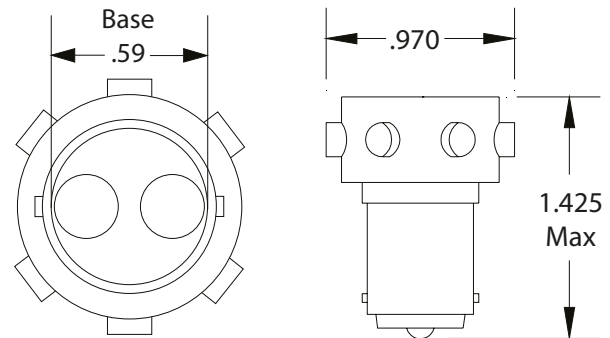

All dimensions are in inches.

#### HOW TO ORDER

Example:

460 - 24 1

MODEL NO.

VOLTAGE

COLOR

# Model 510

## T-1 3/4 LED Direct Replacement for Flange Base Incandescent Lamp

The 510 Model is an LED replacement for incandescent lamps in a variety of colors and voltages. Direct replacement for T-1 3/4 flange base incandescent lamps. Nickel plated base.

- Direct replacement for: 327, 328, 330, 332, 345, 349, 350, 356, 377, 380, 381, 382, 387, 394, 8918
- Available with negative center

### Specifications

#### Model 510

LED size	5 mm
Lens color	Waterclear

#### Warm Colors

LED color	Red	Yellow	Amber
Typical luminous intensity	500 MCD	400 MCD	380 MCD
Viewing angle	40°	110°	100°
Wavelength	R660	Y595	O610

#### Cool Colors

LED color	Green	Ultra Green	Ultra Blue	White
Typical luminous intensity	16 MCD	2200 MCD	250 MCD	6000 MCD
Viewing angle	40°	30°	30°	50°
Wavelength	G565	G525	B470	-

#### Positive Center

Part number	Voltage
510-5X	5 VDC
510-12X	12 VDC
510-14X	14 VDC
510-24X	24 VDC
510-28X	28 VDC

Where the 'X' appears insert:  
1-Red, 2-Green,  
3-Yellow, 4-Amber,  
7-Pure White

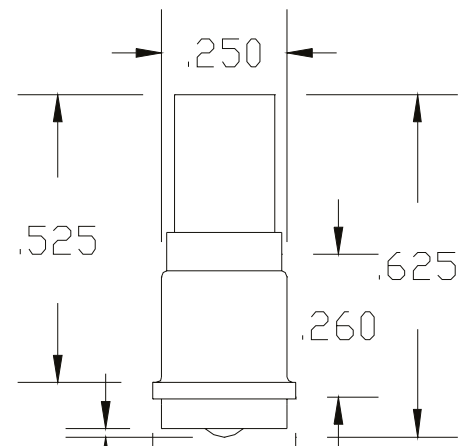

All dimensions are in inches.

#### HOW TO ORDER

Example:

510 - 5 1

MODEL NO.

VOLTAGE

COLOR

# Model 513

## T-1 3/4 LED Replacement for Incandescent Lamps

T-1 3/4 Wedge base LED. Direct replacement for T-1 3/4 wedge base incandescent lamps.

- Direct replacement for: 11, 17, 18, 37, 56, 73, 74, 79, 84, 85 and 86

### Specifications

LED size	5 mm
Lens color	Waterclear



Warm Colors			
LED color	Red	Yellow	Amber
Typical luminous intensity	3000 MCD	900 MCD	250 MCD
Viewing angle	30°	30°	30°
Wavelength	R660	Y595	O610

Cool Colors				
LED color	Green	Ultra Green	Ultra Blue	White
Typical luminous intensity	500 MCD	2200 MCD	650 MCD	6000 MCD
Viewing angle	30°	30°	30°	50°
Wavelength	G574	G525	B470	-

Part number	Voltage
513-5X	5 VDC
513-14X	14 VDC
513-28X	28 VDC

Where the 'X' appears insert:  
 1-Red, 2-Green, 3-Yellow, 6-Ultra Blue,  
 7-Pure White

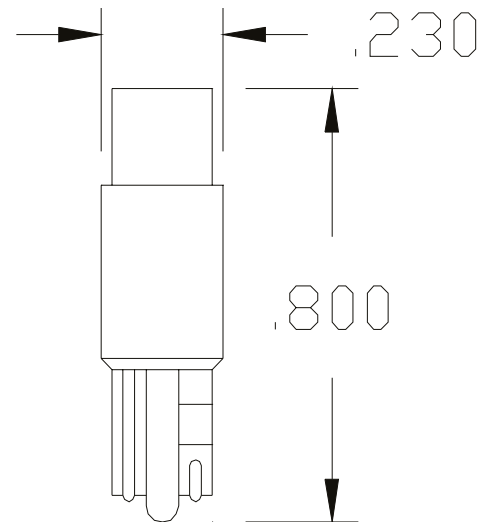

All dimensions are in inches.

#### HOW TO ORDER Example:

513	-	5	1
MODEL NO.		VOLTAGE	COLOR

# Model 516

## T-3 1/4 LED Replacement for Incandescent Lamps

Direct replacement for the T-3 1/4 wedge base bi-pin incandescent lamps.

- Direct replacement for: 124, 147, 152, 158, 159, 161, 168, 184, 190, 192-194, 259, 280, 285, 400, 444, 447, 464, 555, 585, 655, 656, 657, 658, 740, 758, 947, 3-501, 3-504, 3-505, 3-507

### Specifications

LED size	5 mm
Lens color	Waterclear

#### Warm Colors

LED color	Red	Yellow	Amber
Typical luminous intensity	4000 MCD	3000 MCD	4000 MCD
Viewing angle	22°	22°	18°
Wavelength	R660	Y595	A605

#### Cool Colors

LED color	Green	Ultra Green	Ultra Blue	White
Typical luminous intensity	750 MCD	2200 MCD	650 MCD	6000 MCD
Viewing angle	22°	30°	30°	50°
Wavelength	G568	G525	B470	-

Part number	Voltage
516-12X	12 VDC
516-28X	28 VDC

Where the 'X' appears insert:  
1-Red, 7-Pure White

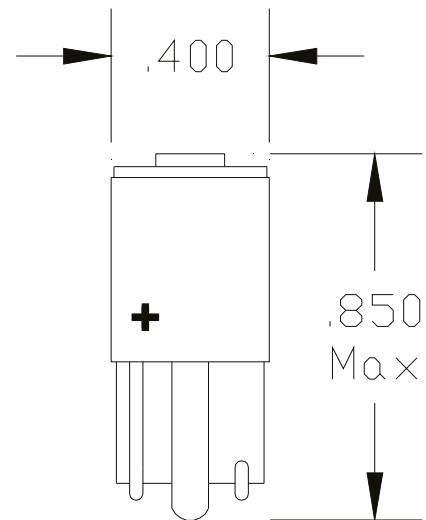

All dimensions are in inches.

#### HOW TO ORDER

Example:

516

-

12

1

MODEL NO.

VOLTAGE

COLOR

**SloanLED Headquarters**

3490 Venture Dr., San Angelo, TX, USA  
325 227 4577 • info@SloanLED.com

**SloanLED Europe b.v.**

Argonstraat 110, 2718 SN Zoetermeer, NL  
+31 88 12 44 900 • europe@SloanLED.com



**SloanLED.com**

